



MINI CHOPPER

MINI CHEF

USER MANUAL

Please read this book carefully before using this appliance.

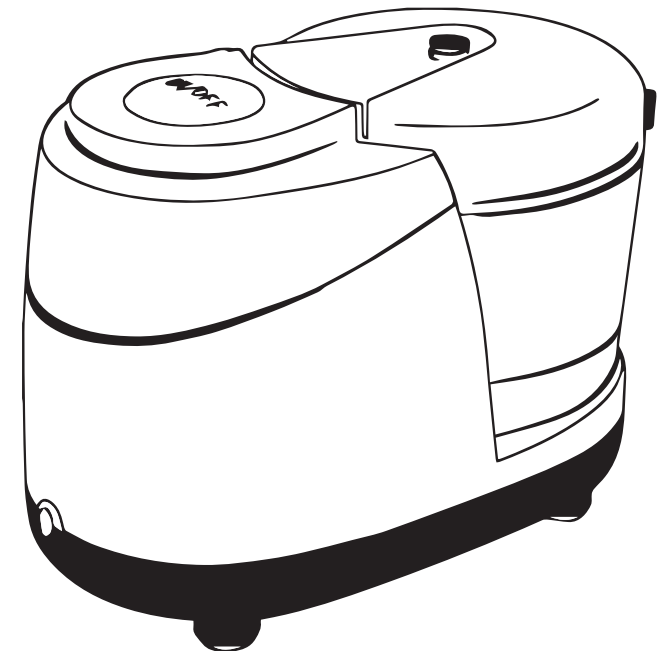

MAXSTAR APPLIANCE LIMITED

1/7, West Patel Nagar, Opposite Pillar No. - 205, New Delhi - 110008

Tel: 08882650660, 011-2588 5791; e-mail: customercare@maxstar.in; Website: www.maxstar.in

AT A GLANCE

Parts

1. Motor unit
2. Button
3. Bowl driver shaft
4. Bowl
5. Chopping blade
6. Lid

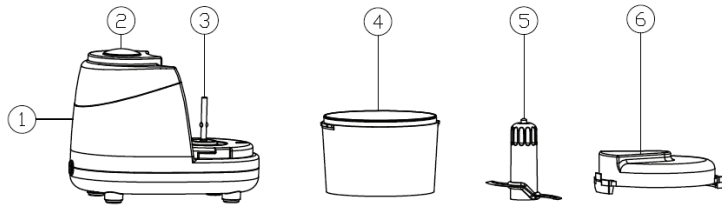

Assembling



Pic 1

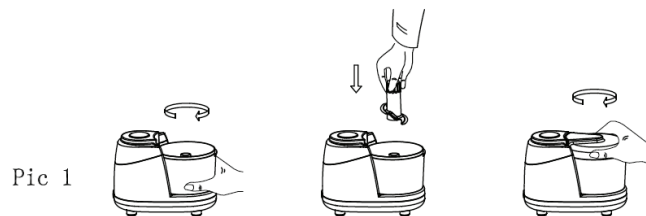

Pic 1

IMPORTANT SAFEGRAUDS

1. Carefully read all instruction before using.
2. Keep hands and utensils away from moving blades or discs while processing food to reduce the risk of severe injury to persons or damage to the food processor. A scraper may be used but must be used only when the food processor is not running.
3. Blades are sharp. Handle carefully.
4. To reduce the risk of injury, never place cutting blade or discs on base without first putting bowl properly in place.
5. Be certain cover is securely locked in place before operating appliance.
6. Never feed food by hand. Always use food pusher.
7. Do not attempt to defeat the cover interlock mechanism.
8. Do not touch surface that may be hot. Use handles or knobs provided.
9. To protect against electrical shock do not immerse cord, plugs, portable appliances (or other specific part or parts) in water or other liquid.
10. Close supervision is necessary when any appliance is used by or near children.
11. Portable-Remove plug from outlet when the appliance is not in use, before putting on or taking off parts, and before cleaning. Allow to cool before handing.
Permanently installed – Make sure appliance is OFF when not in use, before putting on or taking off parts, and before cleaning.
12. Portable Do not operate any appliance with a damaged cord or after the appliance malfunctions or is dropped or damaged in any manner. Return appliance to the nearest authorized service facility for examination, repair, or electrical or mechanical adjustment.
13. The use of accessory attachments not recommended by the appliance manufacturer may cause injuries.
14. Do not use outdoors (this item may be omitted if the product is specifically intended for outdoor use).
15. Do not let cord hang over edge of table or counter or touch hot surfaces.
16. Do not place on or near a hot gas or electric burner or in a heated oven.
17. Extreme caution must be used when moving an appliance containing hot oil or other hot liquids.
18. Where applicable, always attach plug to appliance and check that the control is OFF before plugging cord into wall outlet. To disconnect, turn the control to OFF, then remove plug from wall outlet.
19. Do not use appliance for other than intended use.
20. Avoid contacting moving parts.
21. Never attempt to take food or liquid out from the bowl when the blade is moving.
Always wait until the motor stops completely.
22. Do not overload the appliance with food.
23. The appliance operates fast and effective.
- Do not operate the machine without loading more than 5 seconds.**
- Do not operate continuously for more than 20 seconds.**
24. Never place hot ingredients into processor ($>70^{\circ}\text{C}$).
25. The marked power is just for chopping meat.

SAVE THESE INSTRUCTIONS

FOOD PROCESSOR ASSEMBLING

1. Before the first using, wash all removable parts in warm soapy water, rinse thoroughly and dry. Wipe the housing with a damp cloth.
2. Never immerse motor body in any liquid or wash under running water.
3. Place the motor unit on a level surface.
4. Align the rib under the bowl with the corresponding slot on the motor unit. Turn gently until it locks in position.

ATTACHMENTS

CUTTING KNIFE

1. Fit the cutting knife on the drive spindle.
2. Load products to be processed in the bowl.
3. Place lid on the bowl and rotate it to lock..

SUPPORTING DISC (GRATING/SLICING)

1. Place the shooting disc on the drive spindle.
2. Fit the reversible grating/ slicing disc over the shooting disc with desired cutting blade facing upward.

NOTE: You must complete assembling fully; otherwise you cannot switch on device.

CAUTION: Depend on the majority of foodstuffs, it is advisable to activate the Pulse button momentarily a few time s in succession and then to continue operating until the required degree of fineness has been achieved.

Caution: Don't use this product to chop flour.

Do not remove any parts during the operation.

SOME PRODUCTS PROCESSING

USING THE CUTTING KNIFE

To avoid blades damage do not process hard items such as frozen foods, ice, cereals, rice, spices and coffee.

Type of food	Preparation	Max amount at on time	Time approximate
Meat	Remove skin and sinew, cut into 1.5cm pieces, fill with 80ml water or other liquid spice	150g	20sec.
Fish	Remove bones and skin, cut into 2cm cubes	100g	10-20sec.
Onions	Peel and cut into 2-3cm pieces	70g	7 short bursts
Garlic	Peel	3 cloves	5sec.
Apple (raw)	Peel, remove cores and cut into 2cm pieces	100g	10-15sec.
Carrots	Peel and cut into 2cm pieces	140g	20sec.
Cabbage	Remove the core and cut into 2cm pieces	70g	5sec.
Tomatoes	Cut each into 4-6 pieces	70g	10-15sec.
Mushroom	Quarter for best results.	1/2cup	10-15sec.

When processing is finished, switch off, and then unplug the appliance and wait the motor will stop before removing a food and attachments.

CLEANING AND CARE

1. Switch off and unplug the appliance.
2. Wash the accessories immediately and avoid soaking them in water for long periods; wash in warm sudsy water after each use. Dry all accessories with a clean cloth. Do not use a dish washing machine.
3. Wipe housing with a damp cloth.
4. Do not use scouring pads, abrasive and harsh detergents.
5. Do not immerse the motor unit in any liquid or in a dishwasher.

CAUTION: The blades are extremely sharp and therefore dangerous. Handle with caution!

STORAGE

Be sure that the appliance is unplugged.

Compete all requirements of Chapter CLEANING AND CARE.

Keep the appliance in a dry clean place.



MINI CHOPPER
MINI CHEF

RATING : 220-240V,50 HZ

POWER : 250W



WARRANTY CARD

WARRANTY

(As per terms and conditions overleaf)

Name of Purchaser : _____

Address : _____

Phone No. Residence : _____

Office : _____

Product Sl. No. : _____ Date Of Purchase : _____

Customer's Signature	Dealer's Stamp & Signature

MAXSTAR APPLIANCE LIMITED

1/7, West Patel Nagar, Opposite Pillar No. - 205, New Delhi - 110008

Tel: 08882650660, 011-2588 5791; e-mail: customercare@maxstar.in; Website: www.maxstar.in

Please preserve the Warranty Card and Cash Memo and ensure that they are duly stamped and signed by the Company's dealer. The Warranty Card or a Cash Memo which is not stamped and signed by the dealer will be treated as invalid.

Max Star product that you have bought is of excellent quality and construction. However we will correct, free of charge any defects in material or workmanship for a period of one year* (the Warranty period) from date of purchase subject to the terms and conditions.

TERMS & CONDITIONS OF WARRANTY

1. Max Star products are warrantied solely against poor workmanship, manufacturing defect and use of faulty material only. Consequential liabilities will not be entertained. All Max Star products are designed for domestic usage only.
2. In the event of a replacement of spares during the warranty period, this warranty card will be required along with the original tax invoice/ Cash Memo to process the claim. The Company will not entertain a claim with incomplete warranty details.
3. This warranty is confined to the first purchaser of the product only & is not transferable.
4. Repair or replacement of spares will be carried out through the Company's Authorized Service Centre or its Authorized Dealers.
5. Repairs during warranty period shall be carried on "Carry In" basis, wherein, for services, the purchaser shall bring the product to the Company's Authorized Service Center / Authorized Dealer for warranty service along with Tax Invoice / Cash Memo and Warranty Card. The warranty does not cover cost of transportation of product from the customer's place to the Company's Authorized Service Centre/ Authorized dealer. However, in case the customer located beyond the municipal limits of the jurisdiction of the Company's Authorized Service / Authorized Dealers, wishes the Company / its Authorized Service Center/ Authorized Dealer to collect the product from his place for the purpose of servicing the product then all expenses incurred in collection and delivery back of the product, as well as the expenses incurred in connection with deputation of service personnel / technicians towards to and for travel, conveyance and other incidentals etc. will be borne by the customer.
6. In the event of repairs / replacement of any part/s of the product, this warranty will be thereafter continue and remain in force only for the unexpired period of the warranty. Moreover, the time taken for repair/ replacement and in transit whether under the warranty or otherwise shall not be excluded from the warranty period. The customer shall have to pay a visit charge towards inspection, as applicable.
7. The Company / its Authorized Service Centre/ Authorized Dealer, reserves the right to retain any parts or component/s replaced at its/their discretion in the event of a defect noticed in the equipment during the warranty period. The company shall have exclusive right to replace the defective / unserviceable part/s or component/s with the part/s or component/s which may be new or refurbished.
8. The warranty does not cover accessories external to the product.
9. The warranty does not cover demonstration/installation of the product purchased.
10. In the event of any unforeseen circumstance, and spares not being available, the Company's prevailing depreciation rules will be binding on the purchaser to accept as a commercial solution in lieu of repairs.
11. The warranty is issued at Delhi and Courts at Delhi shall have exclusive jurisdiction over matters covered or flowing from this warranty.
12. The Company's obligation under this warranty shall be limited to repairing or providing replacement of parts, which are found to be defective.
13. In the event of repairs/replacement of specific parts on which warranty is more is more than product warranty, the specific parts will be repaired /replaced free of the cost but customer needs to pay service charges in such cases.

THIS WARRANTY IS NOT APPLICABLE IN ANY OF THE FOLLOWING CASES:

1. The warranty card is not duly filled by the selling dealer.
2. The completed warranty card is not presented to the service personnel at the time of repair.
3. The product is not purchased from an Authorized MAX STAR dealer.
4. The product is not installed, used and maintained according to instruction given in the instruction manual.
5. Defect cause by improper use as determined by the company personnel.
6. Installation/ repair work is carried out by persons/agency other than Authorized by the company.
7. Defects have been caused by reasons beyond control of the Company, like act of God, during transit to Service Centre or purchaser's residence, poor maintenance, damage to the product caused by insects/ rodents.
8. The warranty does not apply to :
 - a. Surface coating, body aesthetics, plastic parts, neon lamps, bake light part, rubber/neon parts, cord wire, push button & bulb and dursable parts viz. shaft, bush etc.
 - b. Normal wear and tears of parts.
 - c. Damages resulting from accidents, mishandling, improper use or negligence on the part of customer and fluctuation in supply voltage.
 - d. Damages resulting due to usage of power supply other than specified 230 Volts AC 50 Hz. e.g. inverters, generator etc.
 - e. For humming noise generated due to usage of electronic fan regulators of any make.
 - f. Breakage of glass parts.
 - g. Heating tubes/rods for failure or breakage.