



MAXSTAR APPLIANCE LIMITED

1/7, West Patel Nagar, Opposite Pillar No. - 205, New Delhi - 110008

Tel: 08882650660, 011-2588 5791; e-mail: customercare@maxstar.in; Website: www.maxstar.in



JUICER MIXER GRINDER

PLATINUM

USER MANUAL

Please read this book carefully before using this appliance.



IMPORTANT SAFETY INSTRUCTIONS:

- Use the unit only as described in this operating manual.
- Remove all the packaging and marketing materials from the unit before the first use.
- Before using, make sure voltage and frequency indicated on the bottom are the same as your local supply.
- Do not leave the unit unattended while it is turned on or even only plugged into the wall outlet.
- Before plugging in or unplugging the unit from the wall outlet, make sure the switch is OFF.
- When disconnecting the unit from the wall outlet, never pull the power cord. Grasp the plug and disconnect it by pulling.
- Do not allow children or unskilled people to handle the unit. Use the unit out of the reach of these individuals.
- Persons with limited movement capacities, reduced sensory perception, insufficient mental capacity or those who are unaware of the proper handling should use the product only under the supervision of a responsible, aware person.
- Take extra care when using the unit near children.
- Don't let anyone use the unit as a toy.
- Turn the unit off, unplug the power cord from the wall outlet, and let the unit cool before cleaning and after use.
- Do not let the power cord hang loosely over the edge of the work area. Make sure the power cord does not touch hot surfaces.
- Do not let the unit hang loosely on the power cord.
- Do not use the unit if the rotating sieve is damaged.
- Do not use the unit without a correctly mounted pulp container.
- The unit contains sharp parts. Extra care should be taken when cleaning the unit.
- Never remove the upper cover until the rotating sieve has stopped completely.

- Always use the tamper to push food through the opening. Never push in food using your fingers, a fork, spoon, knife or any other object.
- Do not use abrasive or chemically aggressive substances to clean the unit.
- Do not use the unit if it does not operate properly, or if it has been dropped, damaged or exposed to any liquids. Refer the unit to an authorized service center for testing and repair.
- Never use an appliance with a damaged power cord or plug. Contact an authorized service center immediately to have defective components repaired or replaced.
- The unit is not designed for outdoor use.
- The unit is suitable for domestic use only. It is not designed for commercial operation.
- Do not immerse the power cord, plug, or appliance in water or any other liquid.
- Use only accessories recommended by the manufacturer.
- Put the appliance on a flat, steady surface.
- Do not repair the appliance yourself. Contact an authorized service center.

Failure to follow the manufacturer's instructions may lead to refusal of warranty repair.

1. This appliance is not intended for use by persons (including children) with reduced physical, sensory or mental capabilities, or lack of experience and knowledge, unless they have been given supervision or instruction concerning use of the appliance by a person responsible for their safety.
2. Children should be supervised to ensure that they do not play with the appliance.
3. When circuit breaker automatically stops motor due to overloading: after 10 second interval, switch off, unplug. Complete the following instructions, and then resume operation

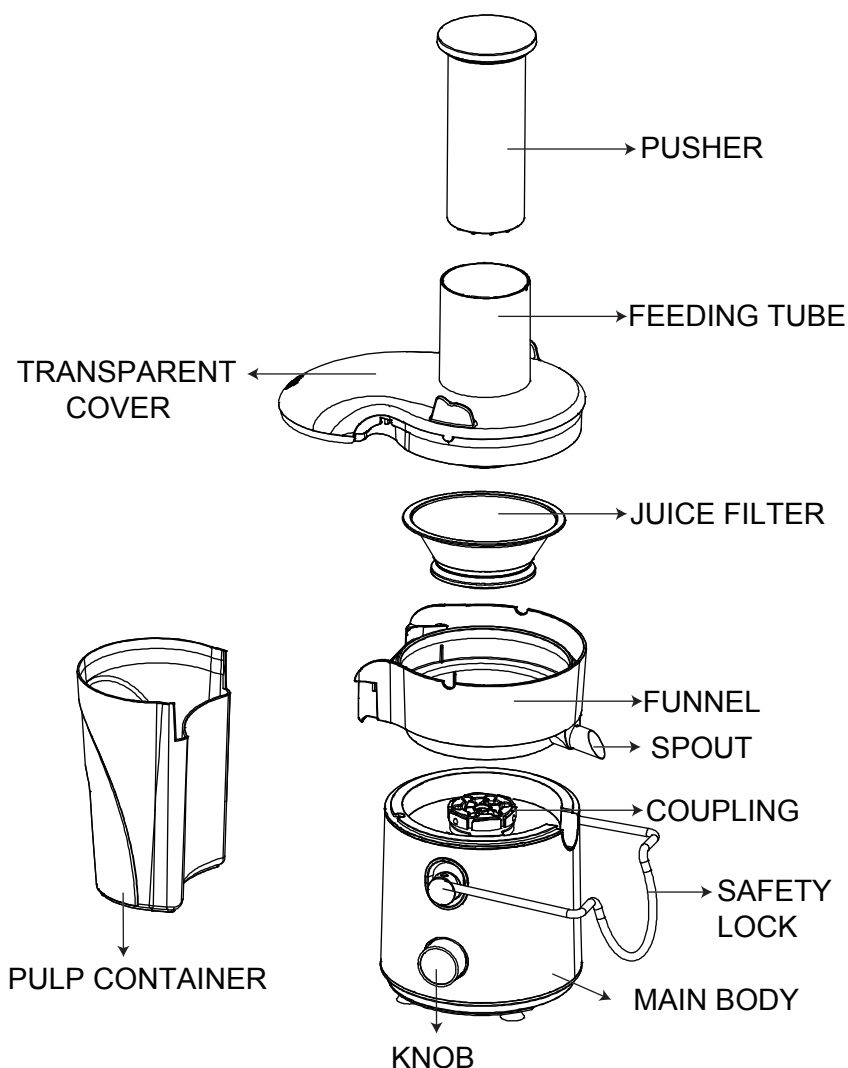

How To Use Juicer

1. Fit the funnel on the main body
2. Fix the juicer filter into coupling and press tightly
3. Put the transparent cover on the funnel.
4. Put the push into the feeding tube of transparent cover.
5. Fix the safety lock by moving it into the groove on the transparent cover. Ensure that the handle is firmly in place.
6. Place the pulp container under residue exit of funnel.
7. Put your cup under the spout
8. Plug into a electric socket
9. Switch the knob to speed "1"
10. Put the clean suitable pieces of vegetable and fruit into the feeding tube and use pusher to press.
11. After the juice and pulp automatically separated, switch the knob to speed "0"
12. After all, please clean the push, cover, filter, funnel, plug.

NOTICE:

1. Make sure Power off before using
2. Must push the transparent cover when lock the handle, otherwise it may switch only one safety switch and not able to operated the machine. If you locked the handle and turn on the machine yet it is no power, please push one time again the Lids for try. It may caused the Safety switch is not connected.
3. All food or Liquid can not over 60°C, and make sure not exceed the max volume of the pulp container.
4. Please note that you need turn the Knob to "1" if deals with soft food such as melon, cucumber, tomatoes, pineapple, etc.
5. Turn the switch to "2" if deal with rigid food such as carrot, apple, celery, beet etc.
6. When it's working, it's forbidden to put your hand or other object into food open of transparent cover;

7. For good effect of juicing, please don't press the pusher rapidly.
8. Shut down the power before cleaning the residue mug.
9. For easy cleaning, suggest place a plastic bag into residue mug to collect residue.
10. Please clean residue mug and residue left in transparent cover in time (suggest clean it after working 1 minute continuously), in order to avoid motor blocked.

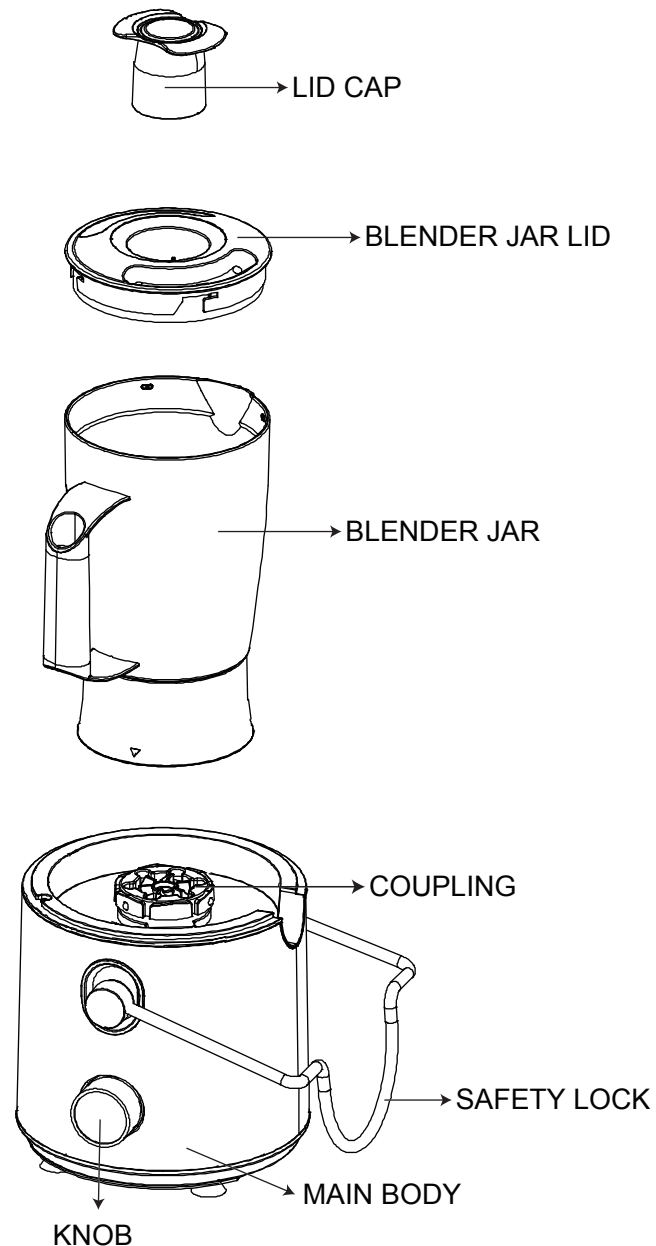
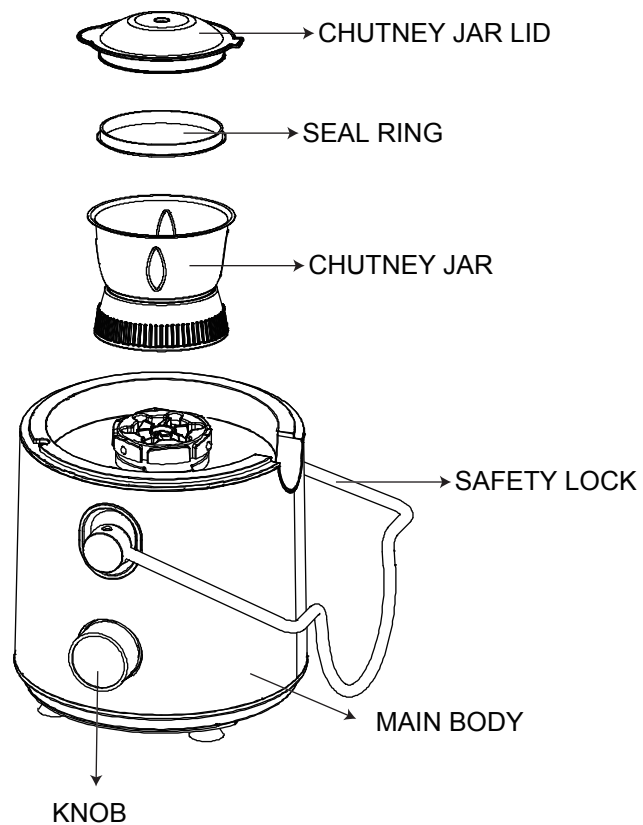

How To Use the Blender/Chutney Jar

- 1.Remove the juicer assembly from the main body.
- 2.Put the blender / chutney jar on the coupling, turn the jar clockwise to fix it on the motor
- 3.Put the ingredients into the jar and place the jar lid firmly on the jar.
- 4.Place your hand on the top of cover.
- 5.Plug into a electric socket
- 6.Switch the knob to required speed
- 7.After all, switch the knob to speed “0”

Notice:

- 1.When without lid, don't assemble the chutney jar on motor, because of sharp edges.**
- 2.Don't run the blender and grinder, when without lid.**

The blender

- Blending fluids, like dairy products, sauces, fruit juices, mixed drinks, and shakes.
 - Mixing soft ingredients, like pancake batter.
 - Pureeing cooked ingredients, like baby food.
 - Crushing small ice.
- 1 Do not exert too much pressure on the handle of the blender jar.

- 2 Never open the lid to put your hand or any object in the jar while the blender is running.
- 3 Always assemble the sealing ring onto the blade unit before you attach the blade unit to the blender jar.
- 4 To add liquid ingredients during processing, pour them into the blender jar through the feeding hole.
- 5 Precut solid ingredients into small pieces before you process them.
- 6 If you want to prepare a large quantity, process small batches of ingredients instead of a large quantity at once.
- 7 To avoid spillage: When you process a liquid that is hot or tends to foam (for example, milk), do not put more than 1.0L of liquid in the blender jar.
- 8 If you are not satisfied with the result, switch off the appliance and stir the ingredients with a spatula.
- 9 Remove some of the contents to process a smaller quantity or add some liquid.

Chutney jar

Function:This jar can be used to grind small quantities of jeera, dhania, green chilli, pepper ,Garam masala, ect.

- Put the ingredients to the ground in the chutney jar .
- Hold the lid and press it down firmly on the chutney jar.Ensuring that the lid has locked securely from all sides.
- Place the chutney jar on the main unit through the jar base .
- The substance to be ground should not be too large to cut / break ingredients into smaller pieces.
- Do not add too much water while using this jar.
- Do not run the mixer continuously as it tends to rob the ingredients of their flavor thus short spurts would be preferable. while dry grinding , friction may heat up the jar ,this is not abnormal

IV. CLEANING

1. Finish using, switch off and pull out plug, disassemble the parts push, cover, filter, funnel, plug, blender jar and chutney jar to wash them by water, then dry and assemble again.
2. Main body can't be cleaned by water, only wiped by wet cloth.
3. In order to have a best extracting effort for each time, the filter net should be cleaned up carefully after using.

V. Attention

1. The machine should be laid on a flat table or place when it is working, then operate it according to the instruction manual.
2. The machine can not work if the safety locks not on position.
3. There has a protect device for high temperature, when the temperature over line then the power will be shut down automatically, and will run again automatically when the motor is cool. (Will takes around 15 minutes)
4. Don't work continuously over 1 minute. The appliance works again until it cools down completely to prolong its service life.
5. If the power cord was damaged, please call up the professionals to maintaining department or change it.
6. The main body is not allowed to clean with water directly; wet cloths, soft brush or sponge can scrub it.
7. Operation by children is not admitted.
8. Please put the juicer extractor in the dry and ventilate place if it is not used for a long time.



MAX STAR

JUICER MIXER GRINDER

PLATINUM

RATING : 220-240V,50/60 HZ

POWER : 600-800 W



2 YEAR WARRANTY ON PRODUCT

5 YEAR WARRANTY ON MOTOR

WARRANTY CARD

WARRANTY

(As per terms and conditions overleaf)

Name of Purchaser : _____

Address : _____

Phone No. Residence : _____

Office : _____

Product Sl. No. : _____ Date Of Purchase : _____

Customer's Signature	Dealer's Stamp & Signature

MAXSTAR APPLIANCE LIMITED

1/7, West Patel Nagar, Opposite Pillar No. - 205, New Delhi - 110008

Tel: 08882650660, 011-2588 5791; e-mail: customercare@maxstar.in; Website: www.maxstar.in

Please preserve the Warranty Card and Cash Memo and ensure that they are duly stamped and signed by the Company's dealer. The Warranty Card or a Cash Memo which is not stamped and signed by the dealer will be treated as invalid.

Max Star product that you have bought is of excellent quality and construction. However we will correct, free of charge any defects in material or workmanship for a period of one year* (the Warranty period) from date of purchase subject to the terms and conditions.

TERMS & CONDITIONS OF WARRANTY

1. Max Star products are warrantied solely against poor workmanship, manufacturing defect and use of faulty material only. Consequential liabilities will not be entertained. All Max Star products are designed for domestic usage only.
2. In the event of a replacement of spares during the warranty period, this warranty card will be required along with the original tax invoice/ Cash Memo to process the claim. The Company will not entertain a claim with incomplete warranty details.
3. This warranty is confined to the first purchaser of the product only & is not transferable.
4. Repair or replacement of spares will be carried out through the Company's Authorized Service Centre or its Authorized Dealers.
5. Repairs during warranty period shall be carried on "Carry In" basis, wherein, for services, the purchaser shall bring the product to the Company's Authorized Service Center / Authorized Dealer for warranty service along with Tax Invoice / Cash Memo and Warranty Card. The warranty does not cover cost of transportation of product from the customer's place to the Company's Authorized Service Centre/ Authorized dealer. However, in case the customer located beyond the municipal limits of the jurisdiction of the Company's Authorized Service / Authorized Dealers, wishes the Company / its Authorized Service Center/ Authorized Dealer to collect the product from his place for the purpose of servicing the product then all expenses incurred in collection and delivery back of the product, as well as the expenses incurred in connection with deputation of service personnel / technicians towards to and for travel, conveyance and other incidentals etc. will be borne by the customer.
6. In the event of repairs / replacement of any part/s of the product, this warranty will be thereafter continue and remain in force only for the unexpired period of the warranty. Moreover, the time taken for repair/ replacement and in transit whether under the warranty or otherwise shall not be excluded from the warranty period. The customer shall have to pay a visit charge towards inspection, as applicable.
7. The Company / its Authorized Service Centre/ Authorized Dealer, reserves the right to retain any parts or component/s replaced at its/their discretion in the event of a defect noticed in the equipment during the warranty period. The company shall have exclusive right to replace the defective / unserviceable part/s or component/s with the part/s or component/s which may be new or refurbished.
8. The warranty does not cover accessories external to the product.
9. The warranty does not cover demonstration/installation of the product purchased.
10. In the event of any unforeseen circumstance, and spares not being available, the Company's prevailing depreciation rules will be binding on the purchaser to accept as a commercial solution in lieu of repairs.
11. The warranty is issued at Delhi and Courts at Delhi shall have exclusive jurisdiction over matters covered or flowing from this warranty.
12. The Company's obligation under this warranty shall be limited to repairing or providing replacement of parts, which are found to be defective.
13. In the event of repairs/replacement of specific parts on which warranty is more is more than product warranty, the specific parts will be repaired /replaced free of the cost but customer needs to pay service charges in such cases.

THIS WARRANTY IS NOT APPLICABLE IN ANY OF THE FOLLOWING CASES:

1. The warranty card is not duly filled by the selling dealer.
2. The completed warranty card is not presented to the service personnel at the time of repair.
3. The product is not purchased from an Authorized MAX STAR dealer.
4. The product is not installed, used and maintained according to instruction given in the instruction manual.
5. Defect cause by improper use as determined by the company personnel.
6. Installation/ repair work is carried out by persons/agency other than Authorized by the company.
7. Defects have been caused by reasons beyond control of the Company, like act of God, during transit to Service Centre or purchaser's residence, poor maintenance, damage to the product caused by insects/ rodents.
8. The warranty does not apply to :
 - a. Surface coating, body aesthetics, plastic parts, neon lamps, bake light part, rubber/neon parts, cord wire, push button & bulb and dursable parts viz. shaft, bush etc.
 - b. Normal wear and tears of parts.
 - c. Damages resulting from accidents, mishandling, improper use or negligence on the part of customer and fluctuation in supply voltage.
 - d. Damages resulting due to usage of power supply other than specified 230 Volts AC 50 Hz. e.g. inverters, generator etc.
 - e. For humming noise generated due to usage of electronic fan regulators of any make.
 - f. Breakage of glass parts.
 - g. Heating tubes/rods for failure or breakage.